

myPhone



myPhone



6670

Contents

1. Quick start guide	5
Installing SIM card and battery.....	5
Installing microSD card.....	6
Charging the battery.....	7
Switching the phone on and off.....	7
2. Your phone	8
Informations about your phone.....	8
Keypad lock.....	10
Keys.....	10
Standby mode.....	11
Shortcuts in standby mode.....	12
Energy thrift.....	12
Flight Mode.....	13
Indicators in flight mode.....	13
Profiles.....	13
3. Call functions	14
Making a call.....	14
Speed dialing call numbers.....	14
Call options.....	14
4. Phone book	15
Add name.....	15
Remove name.....	15
Phonebook settings.....	15
Contact groups.....	16
Search contacts.....	16
Copy contact.....	16
Edit contact.....	17
5. Writing text	17
6. Menu functions	17
7. Messages	17
Text messages (SMS).....	18
MMS.....	18
Writing and sending MMS.....	18
How to read MMS?.....	19

Memory status.....	19
Network messages.....	20
Deleting messages.....	20
Message settings.....	20
8. Multimedia	21
Camera.....	21
Image viewer.....	22
Video.....	22
Video player.....	23
Music player.....	23
Dictaphone.....	24
FM Radio.....	24
File manager.....	24
9. Organizer	25
Bluetooth.....	25
Calendar.....	26
Alarm clock.....	26
World clock.....	26
10. Extra	26
Calculator.....	26
Stopwatch.....	26
Ebook reader.....	26
Network service.....	27
11. Index	27

FOR YOUR SAFETY

First of all, read this simple guideline. Breaking the rules may be dangerous or illegal.

NO RISK

Do not switch the phone on when phone use may cause interference or danger and when phone use is prohibited.

ROAD SAFETY COMES FIRST

Do not use hand - held phone while driving.

INTERFERENCE

All wireless phones may get interference, which could affect performance.

SWITCH OFF ZONES

Do not use phone at a refuelling point.

Do not use near fuel or chemicals.

Do not use phone in aircraft. Wireless can cause interference in aircraft.

Switch the phone off near medical equipment.

PROFRSSIONAL SERVICE

Only qualified personnel may install or repair phone and phone equipment.

BATERIES AND ACCESSORIES

Use only approved batteries and accessories. Do not connect incompatible product.

WATER - RESISTANCE

Keep your telephone dry. Phone is not water - resistant.

1. Quick start guide

Installing SIM card and battery

Keep all SIM cards out of the reach of small children. For availability and information on using SIM card services, contact your SIM card vendor. This may be the service provider, network operator, or other vendor.

The SIM card and its contacts can easily be damaged by scratches or bending, so be careful when handling, inserting or removing the card.

Before installing the SIM card, always make sure that the phone is switched off and then remove the battery.

1. To remove the back cover of the phone

With the back of the phone facing you, push the back cover and remove the cover off the phone.

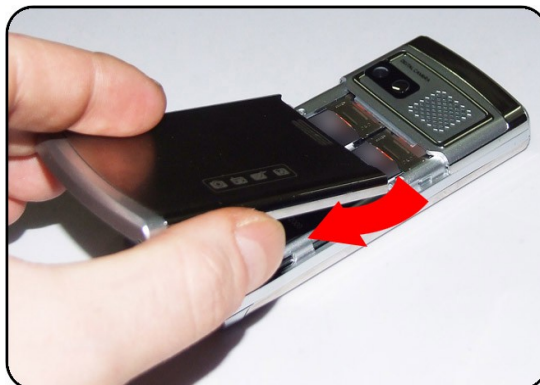

2. Remove the battery by lifting it from the finger grip.

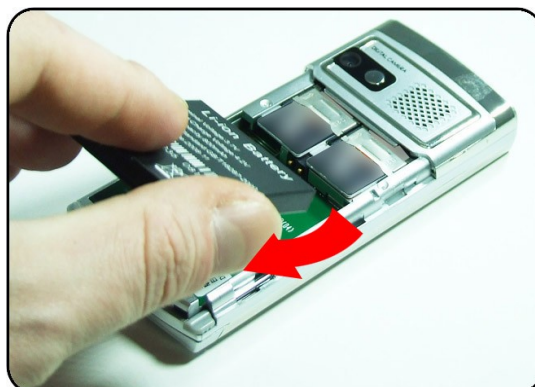

Insert the SIM card 1 into the SIM card 1 holder (SIM1), thereafter do the same thing in second SIM card (SIM2).

Make sure that the SIM cards are properly inserted and that the golden contact area on the card is facing downwards.

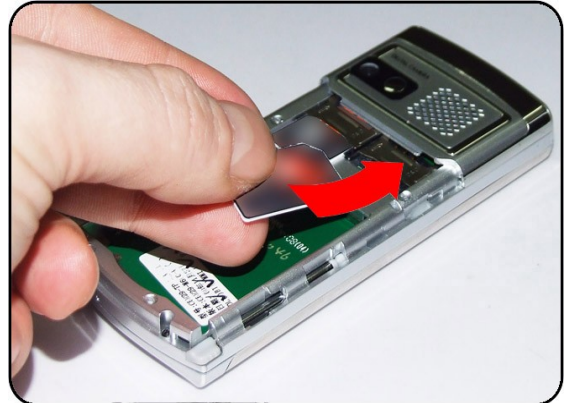
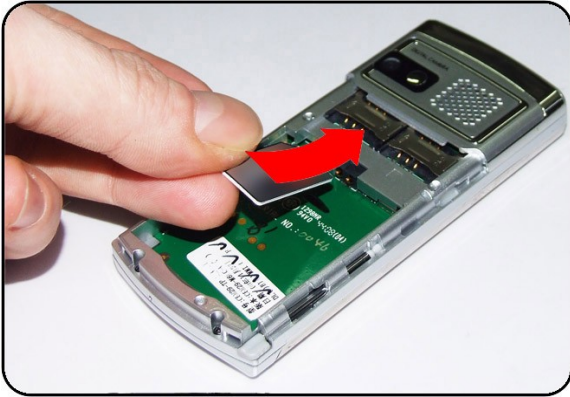

3. Replace the battery and the back cover.

Direct the back cover towards the locking catches on the both sides of the phone and press to lock the cover into its place.

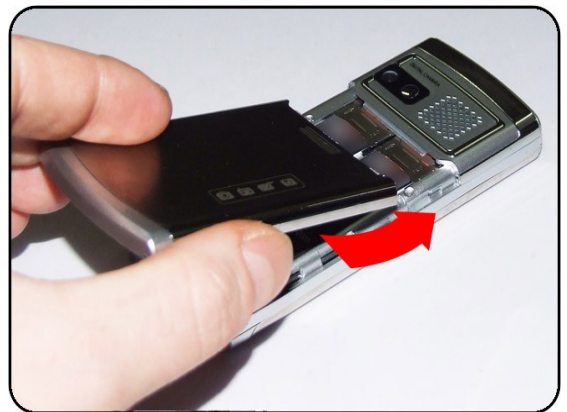
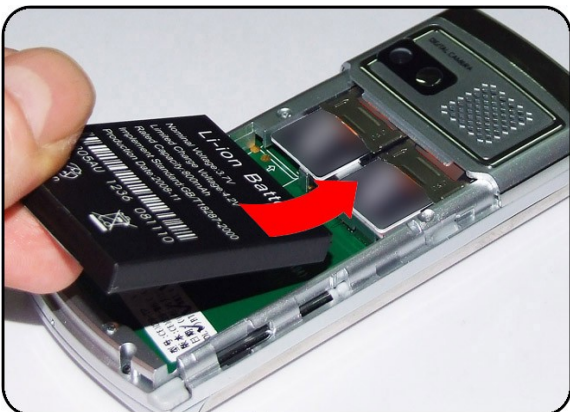

Installing microSD card

1. Before installing the microSD card, always make sure that the phone is switched off. Then You can remove the battery.
2. The place to insert microSD card is located beneath the SIM card 1 holder (Picture 1).
3. Insert the microSD card into the microSD card holder.
4. Insert the battery and replace the back cover.

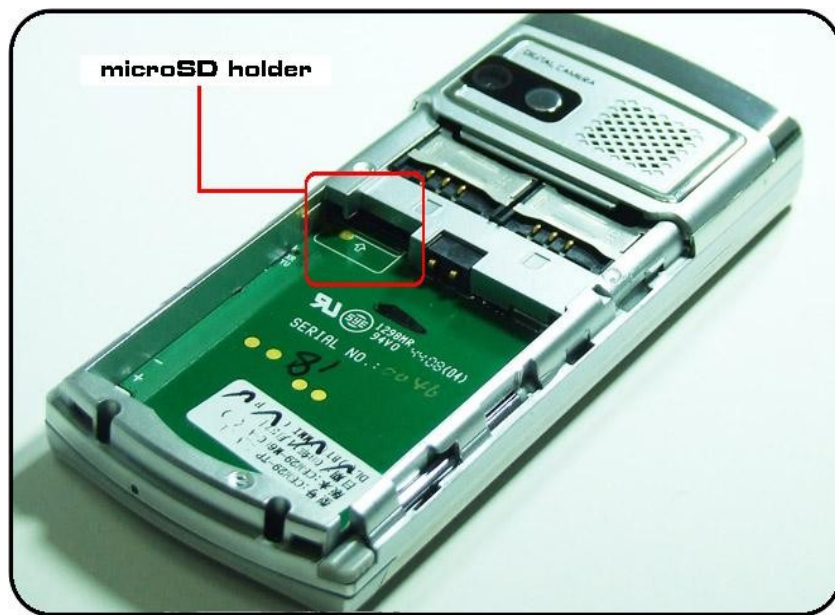

Picture 1

Charging the battery

Your phone is powered by rechargeable battery.

Use only **myPhone** products. Using different products may cancel warranty, damage your phone and might be even dangerous for your health.

Before charging, check the name and number. You have to have the MP-S-G battery charger to charge **myPhone 6650**.

1. Connect the charger to the AC wall socket.

2. Connect the lead from the charger to the socket on the side of your phone as it is shown on the picture above.
3. When battery icon located on phone screen is full, switch off the lead from the charger.
4. Switch off battery plug from 230 V outlet.

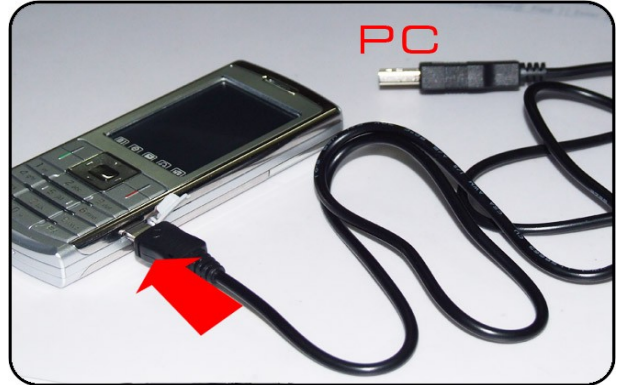

Switching the phone on and off

Do not use phone at a refuelling point (gas station).
Do not use phone near fuel or chemicals.
Do not use phone in aircraft. Wireless can cause interference in aircraft.
Switch the phone off near medical equipment.



If the phone asks for a PIN code, key in the PIN code (displayed as ****), and press OK.

If the phone asks for a security code, key in the code (displayed as ****), and press OK.

Press and hold the power key to switch the phone on and to switch the phone off.

Antenna

Your phone has a built-in antenna.

As with any other radio transmitting device, do not touch the antenna unnecessarily when the phone is switched on. Contact with the antenna affects call quality and may cause the phone to operate at a higher power level than otherwise needed. Not touching the antenna area during a phone call optimises the antenna performance and the talktime of your phone.

Leash and wrist strap

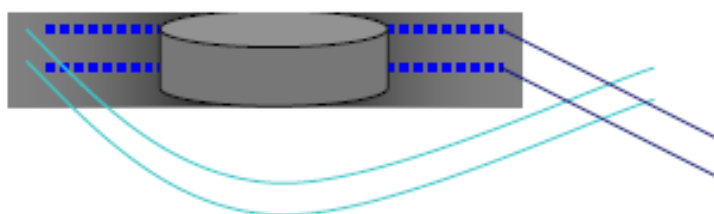

Thread the strap as shown in the picture and then tighten it.

2. Your phone

Information's about your phone

The wireless device described in this guide is approved for use on the GSM 900 and GSM 1800 networks. Contact your service provider for more information about networks.

When using the features in this device, obey all laws and respect the privacy and legitimate rights of others.

To use the phone you must have a service from a wireless service provider. Many of the features in this device depend on features in the wireless network to function. These network services may not be available on all networks, or you may have to make specific arrangements with your service provider before you can utilize network services. Your service provider may need to give you additional instructions for their use and explain what charges will apply. Some networks may have limitations that affect how you can use network services. For instance, some networks may not support all language-dependent characters and services.

myPhone6650 technical specification:

Networks:	90 / 1800 MHz
Dimensions, weight:	108 x 48 x 16 mm, 108 g

Display unit:	2,2", 176 x 220 pixels
Display unit colors:	262 thousand colors
Phonebook memory:	800 items
Feeding Battery:	MP-U-1 (750 mAh)
Talk time:	up to 6 hours
Standby time:	up to 10 days
Memory:	250 kB
Card sot:	Yes, microSD
Messages:	SMS, MMS
Multimedia:	WAP, Bluetooth, USB, PictBridge, Radio, Dictaphone, Games
Sound formats:	amr, midi, mp3, wav
Camera:	640 x 480 px
Picture formats:	bmp, gif, jpg, png
Display resolution:	176 x 144 px
Movie formats:	3gp, avi, mpeg4
Additional functions:	Alarm clock, Calendar, Calculator, Organizer (Datebook), Stop-Watch, Clock, Money Scaler, Vibra, Hands free set.

Keypad lock

You can lock the keypad to prevent the keys being accidentally pressed, for example, when your phone is in your handbag.

You can set the keypad of your phone to lock automatically after a preset time delay when the phone is in standby mode and no function of the phone has been used.

In stabdby mode press  and then  to lock.

Keys

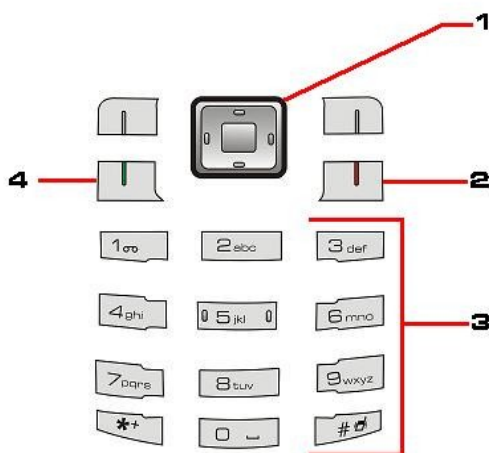

1. 4 - way roll keys

Enables scrolling through names, phone numbers, menus or settings.

2. Power key

Switches the phone on and off and ends an active calls.

3. 0 - 9 keypad

To enter numbers and characters.

4. Dials a phone number, and answers a call.

In standby mode it shows the most recently called number.

Standby mode

When the phone is ready for use, and you have not keyed in any characters, the phone is in standby mode.

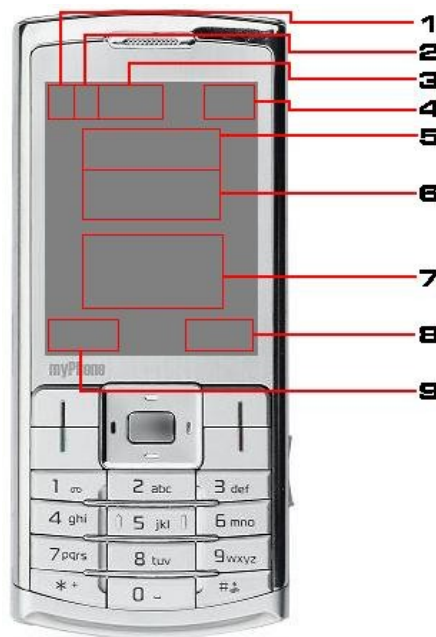

1. Shows the signal strength of the cellular SIM 1 network at your current location. The higher the bar, the stronger the signal.

2. Shows the signal strength of the cellular SIM 2 network at your current location. The higher the bar, the stronger the signal.

3. Keypad lock icon.

4. Shows the battery charge level. The higher the bar, the more power in the battery.

5. and **6.** Cellular network names or logos, the phone is currently being used. (network SIM 1 card name and network SIM 2 card name).

8. The right selection key in standby mode is **Names**.

9. The left selection key in standby mode is **Menu**.

Shortcuts in standby mode

Use 4 - way roll keys as shortcuts.

- Right one - to enter sound settings.
- Left one - to change Profiles.
- Up one - to activate audio player.
- Down one - to enter Alarm settings.



Press “#” button for a while to turn off sounds in Your phone.

Pres “1” button to connect Your Voice Mail. You have to type the Voice Mail number previously.

Energy thrift

1. Switch off the buttons back light:

Menu → Settings → Phone setup → Display characteristic → Power off display

2. Change screen saver appearance time:

Menu → Settings → Phone setup → Display characteristic → Screen saver → Settings → Waiting and select 5 seconds.

Flight Mode

To activate Flight Mode, select:

Menu → Settings → Dual SIM Settings → Flight Mode

Shortcuts in Flight Mode

Shortcuts in Flight Mode are located by using numeric keyboard only.

Indicators in Flight Mode

The most important indicators are:

- Battery state.
- Missed call information.
- Time and data.
- Sound mode.
- New mail.
- Keypad lock icon.
- Network range.

Profiles

Your phone has various setting groups, profiles, for which you can customise the phone tones for different events and environments. Initially, personalise the profiles to your own liking and then you only need to activate a profile to use it.

To change profile, select:

Menu → User Profiles → click Options → Customize

User Profiles list:

- *General*
- *Meeting* (all sounds are off)
- *Outdoor* (loud speaker mode on)
- *Indoor* (all sounds are in quiet mode)
- *Headset* (only when headset is in use)
- *Bluetooth* (when Bluetooth is on)

What You can change in User Profiles:

- *Tone setup*
- *Volume*
- *Alert type*
- *Ring type*
- *Extra tone*
- *Answer mode*



3. Call functions

Making a call

To make a call:

1. Type the phone number, including the area code, than press  to call number.

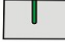
For international calls, press twice * for the international prefix (the + character replaces the international access code) and then key in the country code, area code without the leading, if necessary, and the phone number.

2. To make a call using SIM card, select **Phone book**, select the correct contact data, and press  to make a call.
3. Press  to answer the incoming call and press  to end the call.
4. Press  to reject the incoming call.

Speed dialing a phone number

The names and phone numbers assigned to the speed dialing keys, from 2 to 9, can be dialled by pressing the button and .

Call options

- Reject the incoming call.
- End the call.

- New call.
- Contacts.
- Messages.
- Dictaphone.
- Pitch.
- DTMF.

4. Phone book

Add name

To add new contact, select:

Menu → Phonebook → Add new contact

and select the place to save between: *To SIM1* card, *To SIM2* card, *To phone*.



You can also add new contact by pressing: , thereafter type contact number and press this button again to save.

Remove name

To remove name from contact list, select:

Menu → Phonebook → Delete

Phonebook settings

You can:

- Check the memory status.
- Select the place to save contact.
- Type:
 - Company name
 - Home number
 - Email address

- Fax number
- Date of birth
- Add picture

When You want to save contact data on SIM card, You can type name and phone number only.

- Change place when the contact are shown.
- Change information's about yourself.
- Change vCard options.

Contact groups

You can arrange the names and phone numbers saved in the phone book into caller groups.

You can change the Group Name:

Menu → Phonebook → Caller Groups → Select Group → Press OK

For each caller group, you can set the phone to sound a specific ringing tone and show a selected graphic on the display when you receive a call from a phone number in the group.

To change the phone sound You have to select **Confirm sound**.

Search contacts

To find contact You want to call, select:

Menu → Phonebook → Search contact

and type contact name.

You can also select:

Menu → Phonebook → Quick search

to find contact quicker.

Copy contacts

To copy single contact, select:

Menu → Phonebook → Copy

To move single contact, select:

Menu → Phonebook → Move

Edit contact mode

To edit contact, select:

Name → Options → Edit

5. Writing text

You can change the character case by pressing “#”. Press a number key 1 to 9 repeatedly until the desired character appears.

6. Menu functions

You can use your keypad to select menu functions by pressing selected button (when you press “4”, fourth menu option appears on display).

1. To enter menu, select **Menu**.
2. Use 4 - way roll keys to enter option you need.
3. To exit menu, press **Back** or .

7. Messages

You can read, write, send and save text, multimedia, and e-mail messages.

You can also send and receive text messages that contain pictures. Each picture message is made up of several text messages. Therefore, sending one picture message may cost more than sending one text message.

Warning: Messages can have destructive software.

Text messages (SMS)

Your phone can send and receive multi-part messages, which consist of several ordinary text messages (network service). Invoicing is based on the number of ordinary messages that are required for a multi-part message.

You can also send and receive text messages that contain pictures. Each picture message is made up of several text messages. Therefore, sending one picture message may cost more than sending one text message.

To write SMS message, select:

Menu → Messages → SMS → Write message

type text, and after that, select SIM card between SIM card 1 and SIM card 2 to sent your message.

If you chose **Send to many** option, select **Edit list → Options → Edit**, type number and send message.

If you chose **Save and send** or **Send** option, type number and send message.

If you want to chose number from your contacts list, press **Search**, after choosing contact, press **OK** and send.

Multimedia Messaging Service (MMS)

This function can be used only if it is supported by your network operator or service provider. Only phones that offer multimedia message features can receive and display multimedia messages. A multimedia message can contain text, picture and sound.

Writing and sending multimedia messages

1. To write message, select: **Menu → Messages → MMS → Write message**.
2. Type topic: **Options → Edit**.
3. Type message text: **Subject (Options → Edit)**.

4. To insert picture, select: **Options** → **Insert** → **Picture**.
5. To insert sound, select: **Options** → **Insert** → **Sound**.
6. To insert addenda, select: **Options** → **Insert** → **Addenda**.
7. To remove picture, sound or another file, select:
Options → **Delete**.
8. You can select: **Options** → **Arrange** → **Text first**, to show text before image in your message.
9. To see MMS message before sending, select: **Options** → **Drafts**.
10. To select your MMS taker, select first place from the top, than select **Add number** and type number and send message.
11. To send MMS copy to another person, select second place from the top, select **Add number** and type number, or select **Names**, chose contact number, press **OK**.

How to read MMS?

1. Press **Read** to read message.
2. When you want to read message one more time, select:
Menu → **Messages** → **MMS** → **Inbox**.
3. To see presentation, select: **Options** → **Play**.
4. To download file from MMS, select **Options** → **Object**, select file, and select: **Options** → **Save**.

Memory status

If the memory is full you can see: **Full memory** text displayed on your screen.

To remove the SMS message, select:

Menu → **Messages** → **SMS** → **Inbox** →
select message → **Options** → **Delete**.

To remove all SMS messages, select:

**Menu → Messages → SMS → Inbox → select message
→ Options → Delete all → Yes.**

To remove the MMS message, select:

**Menu → Messages → MMS → Inbox →
→ select message → Options → Delete.**

To remove the all MMS messages, select:

**Menu → Messages → MMS → Inbox →
→ Options → Delete all → Yes.**

Network messages

With the info message network service you can receive messages on various topics from your service provider, for example weather or traffic conditions. For available topics and the relevant topic numbers, contact your service provider.

Deleting messages

Look at **Memory status**.

Message settings

1. To enter, select: **Menu → Messages → SMS → SMS Settings**.

2. Options:

- *Profile settings*

Change message presentation, change profile name. (You need to select **Edit** to change information)

- *Common settings*

Confirmation about message.

- *Memory status*

Information's about memory status.

- *Preferred storage*

Select between SIM card memory and phone memory to save message.

8. Multimedia

Camera

You can take photos or record video clips with the built-in camera. The camera lens and the camera flash are on the back of the phone, and the display of the phone works as a viewfinder.

1. To make a photo, select: **Menu** → **Multimedia** → **Camera**.
2. To change photo resolution, select: **Options** → **Image settings** → **Image size**.
3. To chose picture quality, select: **Options** → **Image settings** → **Image quality**.
4. To change white balance, select: **Options** → **White balance**, select option and press OK.
5. Select: **Options** → **Effect settings** to change picture effect settings.
6. When You want to make few photos, press 5 button or select: **Options** → **Camera settings** → **Cont. Shot**.
7. To delay taking photo select: **Options** → **Camera settings** → **Delay timer** and type delay time.
8. To change lightness, press left and right scroll keys.
9. Night mode: **Options** → **Scene mode** → **Night** → **OK**.
10. Saving picture: **Options** → **Memory**, select option and press OK.

11. To change between-lens shutter sound, select: **Options** → **Camera settings** → **Sound**.

12. To see photos: **Options** → **Galery**.

13. To restore basic settings, select: **Options** → **Restore default**.

Image viewer

You can see all your pictures in the Gallery.

1. To take a picture, select:

Menu → **Multimedia** → **Camera** → and press



2. To create wallpaper from picture: **Options** → **Forward** → **To wallpaper** → **OK**.

3. To rename picture: **Options** → **Rename**.

4. To delete picture, select picture → **Options** → **Delete** → **Yes**. To delete all pictures, select: **Options** → **Delete all** → **Yes**.

5. To change sorting option, select: **Multimedia** → **Image viewer** → **Options** → **Sort by** → and chose:

- *By name*
- *By type*
- *By time*
- *By size*
- *None*.

Video

1. To record video movie select: **Menu** → **Multimedia** → **Video recorder**.

2. To change video quality, select: **Menu** → **Multimedia** → select **Video Recorder** → **Options** → **Video settings**,

and select between: *Low*, *Normal*, *High*.

3. To change white balance, select: **Options** → **Camcorder settings** →

White balance, select option and press **OK**.

4. Select: **Options** → **Effect settings** to change video effect settings.
5. Night mode: **Options** → **Camcorder settings** → **Night Mode (ON)** → **OK**.
6. **Options** → **Storage** → Select option to save video.
7. To change frequency, select: **Options** → **Camcorder settings** → **Banding**. Select between 50 MHz and 60 MHz.
8. Select: **Options** → **Effect settings** to change video effect settings.
9. To restore basic settings, select: **Options** → **Restore default**.

Video player

1. To see video select: **Menu** → **Multimedia** → **Video Player**.
2. To play, press OK or 
3. To play louder, press **2**, to play quietly, press **8**.
4. To play video in full screen mode, press *****.
5. To play video in normal mode, press **#**.
6. To crank sound up and down, use right and left navigation button.

Music player

1.  Press up button (above OK) to play music.
2. Press up button (above OK) to stop music.
3. To move forward, press right button and to go back, press left button.
4. Press OK to see music list.
5. **List** → **Settings** → **Repeat** to repeat song.
6. **List** → **Settings** → **Refresh list** to refresh playlist.
7. **List** → **Settings** → **List auto gen.** to play from list.

Dictaphone

Select: **Menu** → **Multimedia** → **Sound recorder** → **Options** → **Record** to record sound.

Select: **Options** → **Settings** → **Audio quality** to change recording quality.

Select: **Options** → **Settings** → **Format** to select saving file format (wav, awb, amr).

FM Radio

The FM radio depends on an antenna other than the wireless device antenna. A compatible headset or enhancement needs to be attached to the device for the FM radio to function properly.

Select: **Menu** → **FM Radio** to listen to the radio.

Select: **Menu** → **FM Radio** → **Options** → **Channel list** chose free space, select **Options** → **Edit** ant type channel name and frequency to save radio station.

Select: **Menu** → **Multimedia** → **FM Radio** → **Options** → **Settings** → **Background Play** → **ON** to listen radio in background mode.

Select: **Menu** → **Multimedia** → **FM Radio** → **Options** → **Settings** → **Loud speaker** → **ON** to listen to the radio louder.

Use  and  to adjust volume.

File manager

You can view files and add files here.

1. To create folder, select: **Options** → **New folder** → Enter folder name → **Options** → **Done**
2. To remove folder, select folder, thereafter: **Options** → **Delete** → **Yes**.
3. To remove file, select file, thereafter: **Options** → **Delete** → **Yes**.
4. To move files select file, thereafter select: **Options** → **Move** and select destination area.

5. To copy file, select file, thereafter: **Options** → **Copy**.
6. To change file name, select file, thereafter: **Options** → **Rename**.
7. **Options** → **Details** to see file details.
8. Send file via Bluetooth™: **Options** → **Forward** → **To Bluetooth™** → **Inquiry new device**.
9. To memory format select: **Options** → **Format** → **OK**.

9. Organizer

Bluetooth™

Bluetooth technology allows you to connect your phone using radio waves to a compatible Bluetooth device within 10 meters (32 feet).

Select: **Menu** → **Organizer** → **Bluetooth™** to take following steps:

1. Select: **Menu** → **Organizer** → **Bluetooth™** → **Power (ON)** to activate Bluetooth connectivity.
2. To connect your phone with an audio enhancement, select **Inquiry audio device** and the device that you want to connect.
3. To connect your phone with any Bluetooth device in range, select **Bluetooth** → **Active devices**.

Enter a passcode (up to 16 characters) on your phone and allow the connection on the other Bluetooth device.

If you are concerned about security, turn off the Bluetooth function, or set **Visibility**: **Menu** → **Organizer** → **Bluetooth** → **Settings** → **Visibility (OFF)**. Always accept only Bluetooth communication from others whom you trust.

Calendar

To enter: **Menu** → **Organizer** → **Calendar**.

- You can check date
- You can make a calendar note
- Scroll to the date you want, select **Options** → **Add task**. Select one of the following note types.

Select if You want alarm or not, select priority.

Alarm clock

You can set the phone to sound an alarm at a desired time.

To set the alarm, select **Menu** → **Organizer** → **Alarm**, enter the alarm time (**Edit**) and **Save**. Select **Repeat alarm** to set the phone to alert you on selected days of the week.

Select **Edit** → **On** to activate alarm clock.

World clock

You can see actual time in different time zones. Select: **Menu** → **Organizer** → **World clock** and



to see time in different time zones.

10. Extra

Calculator

To enter, select: **Menu** → **Extra** → **Calculator**.

When **0** is displayed on the screen, enter the first number in the calculation. Press **#** for a decimal point. Scroll to the desired operation or function, and enter the second number. Repeat this sequence as many times as it is necessary.

Stopwatch

To enter stopwatch, select: **Menu** → **Extra** → **Stopwatch** and from the following options:

- **Split timing** — to take intermediate times. To reset the time without saving it, select **Reset**.
- **Lap timing** — to take lap times.

Ebook reader

To enter ebook reader, select: **Menu** → **Extra** → **Ebook reader**.

Network services

You may receive the settings directly as a configuration message, and you need to save the settings on your phone. The service provider may provide a PIN that is needed to save the settings. For more information on the availability of the settings, contact your network operator, service provider, nearest authorised MyPhone dealer contact the support area: support@myphone.pl.

11. Index

myPhone

www.myphone-mobile.com

